

SD BIO LINE H.pylori Ag



One Step H.pylori Antigen Test

Helicobacter pylori (H. pylori) is a spiral-shaped bacterium and that is found in the gastric mucous layer or adherent to the epithelial lining of the stomach. H. pylori causes more than 90% of duodenal ulcers and up to 80% of gastric ulcers. The immunochromatographic techniques (rapid) for the detection of H. pylori antigen has substantially resolved these problems, ensuring a serological monitoring in a very short space of time using simple, highly specific technology without recourse to invasive techniques.

General Information

SD BIOLINE H.pylori Ag kit is a rapid, qualitative test for the detection of Helicobacter pylori antigen in human faecal specimens.

- Easy to use: No need of any equipment
- Fast Test result: 10-15 minutes
- Specimen: Stool
- Sensitivity: 98.3% / Specificity: 100%

Materials Provided

- SD BIOLINE H.pylori Ag test device
- Sample collection tube
- Assay diluent
- Sample collection swab
- Disposable dropper
- Disposable dropping cap

Test Procedure

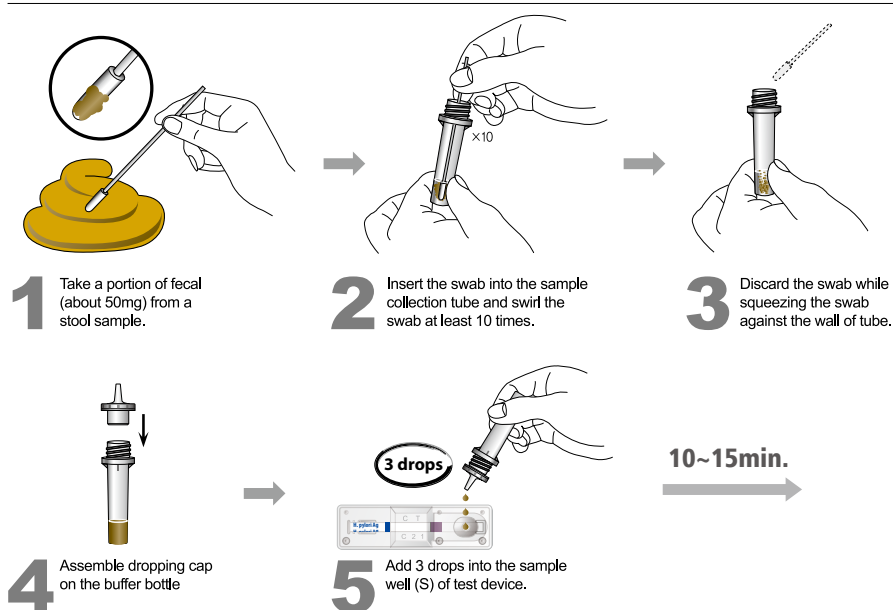

Interpretation

Negative



Positive

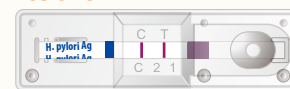

Invalid

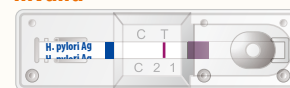

Ordering Information

Cat. No.	Description	Specimen	Type	Pack size
04FK20	H.pylori Ag	Stool	Device	1Tx20/Kit